



ALPHA

Owner's Manual



PRE-CHARGED PNEUMATIC AIR RIFLE

CONTENTS

Rules for Safe Shooting..... 4

Parts of your Air Rifle..... 5

Operating the Safety..... 6

Filling your Alpha 7

Depressuring the Air Rifle..... 8

Loading the Rotary Magazine..... 9

Inserting the Rotary Magazine..... 9

Folding & Removing the Stock 10

Loading & Shooting Instructions..... 11

Trigger Adjustments..... 12

Maintenance..... 13

Troubleshooting..... 14

Warranty Information..... 15

ALWAYS FOLLOW THESE SAFETY WARNINGS

! WARNING: NOT A TOY. THIS AIR RIFLE IS INTENDED FOR ADULT USE ONLY. MIS-USE OR CARELESS USE MAY CAUSE SERIOUS INJURY OR DEATH. MAY BE DANGEROUS UP TO 1,000 YARDS (914 METERS).

! WARNING: DO NOT BRANDISH OR DISPLAY THIS AIRGUN IN PUBLIC; IT MAY CONFUSE PEOPLE AND MAY BE A CRIME. POLICE AND OTHERS MAY THINK IT IS A FIREARM. DO NOT CHANGE THE COLORATION OR MARKINGS TO MAKE IT LOOK MORE LIKE A FIREARM. THAT IS DANGEROUS AND MAY BE A CRIME.

! WARNING: THIS IS A HIGH POWERED AIRGUN INTENDED FOR USE BY THOSE 18 YEARS OF AGE OR OLDER. READ ALL INSTRUCTIONS BEFORE USING. BUYER AND USER HAVE THE DUTY TO OBEY ALL LAWS ABOUT THE USE AND OWNERSHIP OF THIS AIRGUN.

! WARNING: BE SURE THE AIRGUN IS ALWAYS POINTED IN A SAFE DIRECTION. NEVER POINT THE AIRGUN AT ANYONE EVEN IF IT IS UNLOADED. ALWAYS ASSUME AND HANDLE THE AIRGUN AS IF IT WERE LOADED AND READY TO FIRE.

! WARNING: THIS PRODUCT CAN EXPOSE YOU TO CHEMICALS INCLUDING LEAD, WHICH IS KNOWN TO THE STATE OF CALIFORNIA TO CAUSE CANCER AND BIRTH DEFECTS OR OTHER REPRODUCTIVE HARM. FOR MORE INFORMATION GO TO WWW.P65WARNINGS.CA.GOV.

! WARNING: USE ONLY COMPRESSED AIR IN THIS RIFLE. DO NOT USE OTHER GASSES, INCLUDING OXYGEN, WHICH CAN CAUSE A FIRE OR EXPLOSION THAT MAY RESULT IN SERIOUS INJURIES OR DEATH.

! WARNING: TREAT YOUR AIR RIFLE AS IF IT IS ALWAYS LOADED AND READY TO FIRE. ALWAYS KEEP THE MUZZLE POINTED IN A SAFE DIRECTION. BE AWARE OF RICOCHET. NEVER SHOOT AT HARD SURFACES OR INTO WATER.

! WARNING: THE MAXIMUM FILL PRESSURE IS 3,625 PSI (250 BAR). DO NOT FILL PAST THE MAXIMUM PRESSURE.

! IMPORTANT YOU AND OTHERS WITH YOU SHOULD ALWAYS WEAR SAFETY GLASSES TO PROTECT YOUR EYES. READ ALL INSTRUCTIONS BEFORE USING.



RULES OF SAFE SHOOTING

- **NEVER** point the airgun at any person.
- **NEVER** point the airgun at anything you do not intend to shoot.
- **ALWAYS** treat the airgun as if it is loaded and handle it with the same respect you would a firearm.
- **ALWAYS** aim in a **SAFE DIRECTION**. **ALWAYS** keep the muzzle pointed in a **SAFE DIRECTION**.
- **NEVER** put any part of your hand over the muzzle.
- **ALWAYS** keep the airgun **ON "SAFE"** until you are ready to shoot in a **SAFE DIRECTION**.
- Check behind and beyond your target to be certain you have a safe backstop and that no person or property can be endangered.
- Place the backstop in a location that will be safe should the backstop fail.
- Replace the backstop if it becomes worn.
- **ALWAYS** be sure of your target and what lies beyond it in case you miss.
- **NEVER** shoot at hard surfaces, water or anything else that may cause a ricochet.
- This airgun may only be used where your local laws permit or at shooting ranges allowed by the law, and only if the ammunition does not travel further than the shooting area. Keep in mind the maximum range of the ammunition. **ALWAYS** abide by laws and regulations that apply to airguns.
- **ALWAYS** check to see if the airgun is **ON "SAFE"** and unloaded when getting it from another person or from storage.
- **ALWAYS** keep your finger off the trigger and away from the trigger guard until ready to shoot.
- You and others with you should **ALWAYS** wear safety shooting glasses to protect your eyes.
- If your reading or prescription glasses are not certified safety glasses, make sure you wear shooting glasses over your regular glasses.
- The shooter and everyone in the vicinity should wear hearing protection when shooting and filling guns with high pressure air.
- **NEVER** load your gun until you're ready to shoot and it's safe to do so.
- **ALWAYS** use the correct caliber ammunition that is suitable for the airgun. Use **ONLY** ammunition designed for this airgun.
- **NEVER** reuse ammunition.
- **ALWAYS** store the airgun with the safety **ON "SAFE"**, unloaded, uncocked, separated from the ammunition, out of the reach of children, and in a secure location to prevent unauthorized people from accessing it.
- **DO NOT** attempt to disassemble or tamper with the airgun.
- **DO NOT** put the airgun away loaded.
- **ALWAYS** store this airgun in a safe location.
- **ALWAYS** store ammunition separately from the gun.
- **NEVER** leave the airgun loaded if it is out of your reach.
- **ALWAYS** unload the airgun before giving it to someone else.
- **ALWAYS** read and follow the manufacturer's manual and instructions.
- **NEVER** let a person who has not completely read this manual use this product.

PARTS OF YOUR AIR RIFLE

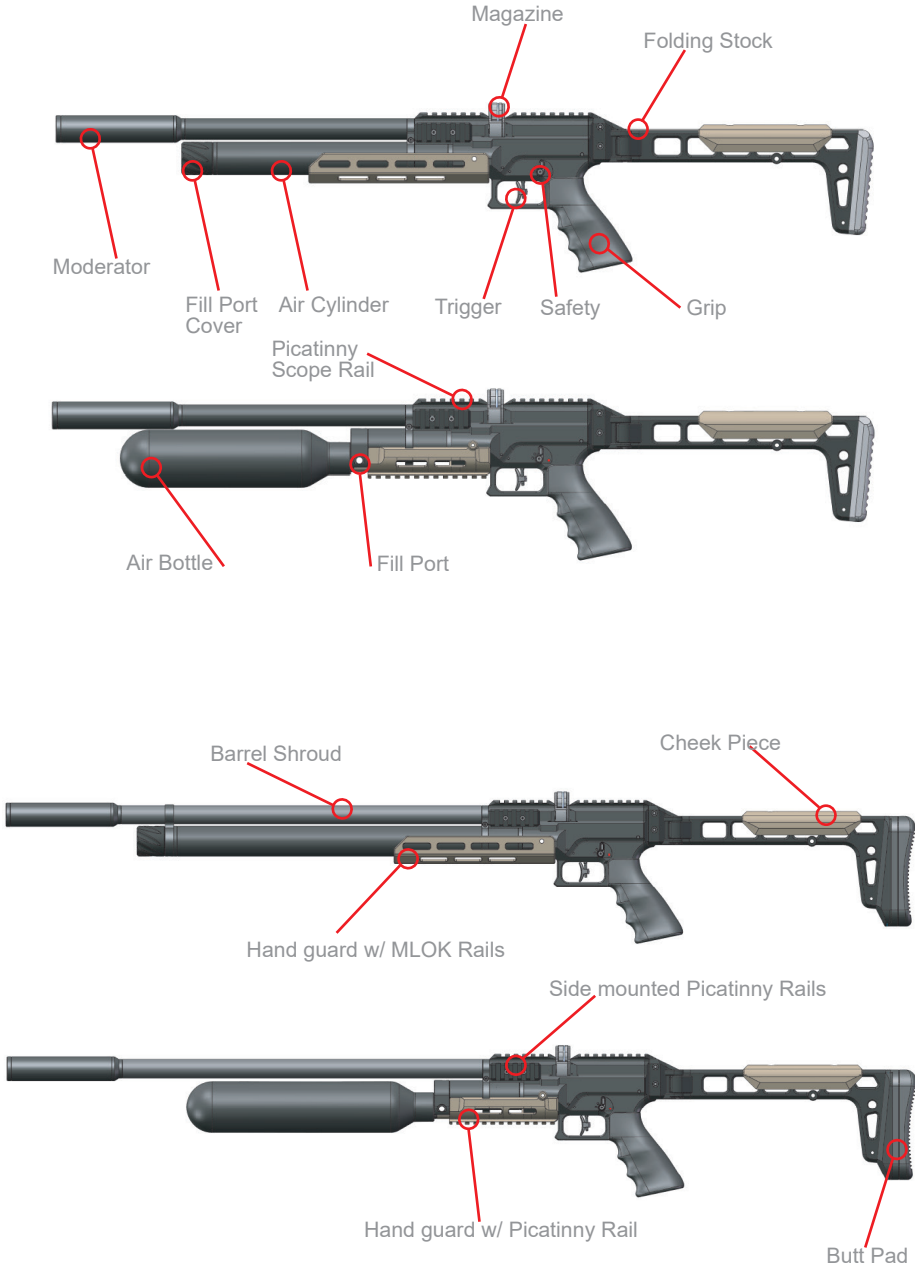

OPERATING THE SAFETY

- 1) The safety is located above the trigger. It allows you to set this air rifle to “S” (SAFE) and “F” (FIRE) positions.
- 2) Setting “S” (SAFE) Position: Rotate the safety switch clockwise by pulling back and down, the safety should cover the red dot. (Fig. 1)
- 3) Setting “F” (FIRE) Position: Rotate the safety switch counter-clockwise by pushing up and forward, exposing the red dot signifying it is ready for shooting. (Fig. 2)

SAFE

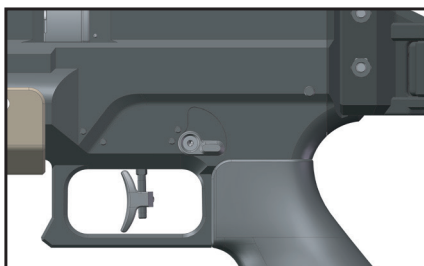

FIRE



⚠ WARNING: LIKE ALL MECHANICAL DEVICES, AN AIR RIFLE SAFETY CAN FAIL. EVEN WHEN THE SAFETY IS SET TO “SAFE” POSITION, CONTINUE HANDLING THE AIR RIFLE SAFELY. NEVER POINT THE AIR RIFLE AT ANY PERSON AND ANYTHING YOU DO NOT INTEND TO SHOOT.

⚠ WARNING: ALWAYS KEEP AIR RIFLE AND THE SAFETY IN THE SAFE POSITION UNTIL YOU ARE ACTUALLY READY TO SHOOT. FAILURE TO FOLLOW THESE INSTRUCTIONS MAY RESULT IN SERIOUS INJURIES OR DEATH.

FILLING YOUR ALPHA WITH COMPRESSED AIR

Note: If you are filling your air rifle from empty, make sure to cock the rifle before filling. Failure to cock the rifle before filling may result in air leaking. Always engage the safety before attempting to fill.

1) Make sure the air rifle is unloaded, the Safety is on (SAFE) position and keep the muzzle pointed in a safe direction. Be sure to wear eye protection.

2) For tube models: Locate the protective cap on the reservoir and pull forward to expose the fill port hole. Insert the fill probe into the fill port hole (Fig 1).

For bottle models: Locate the fill port hole and insert the fill probe (Fig 2).

3) Connect the female quick connector from your fill device to the male quick connector on the probe (Fig 3). Make sure the collar on the female fitting is in the forward, locked position (Fig 4.) Check this by trying to pull the fitting off of the probe to make sure it is locked in.

4) When filling is completed, bleed the pressure in your fill device and disconnect the female quick connector from the male quick connector.

5) Remove the fill probe from the fill port hole.

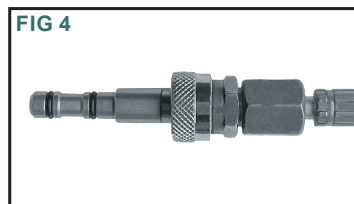
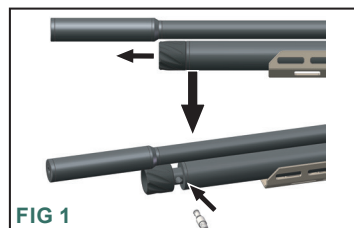

| | |
|---|--|
| ⚠ DANGER | |
|  | DANGER OF EXPLOSION! Overfilled compressed air cylinder Do NOT exceed maximum fill pressure of your cylinder at room temperature! |

⚠ WARNING: THE AIR SHOULD BE PRESSURIZED SLOWLY. OTHERWISE, HEAT IS GENERATED THAT AFFECTS THE ACCURACY OF THE PRESSURE. OVERPRESSURE CAN CAUSE EXPLOSIONS, SERIOUS INJURIES OR DEATH.

⚠ WARNING: USE ONLY COMPRESSED AIR IN THIS RIFLE. DO NOT USE OTHER GASSES, INCLUDING OXYGEN, WHICH CAN CAUSE A FIRE OR EXPLOSION THAT MAY RESULT IN SERIOUS INJURIES OR DEATH.

⚠ WARNING: THE MAX FILL PRESSURE OF THE AIR RESERVOIR IS 250 BAR / 3,625 PSI. DO NOT FILL PAST THE MAX FILL PRESSURE.

⚠ WARNING: BEFORE YOU DISCONNECT THE FEMALE QUICK CONNECTOR FROM THE RIFLE, THE FILL ASSEMBLY MUST BE DEPRESSURIZED SO THAT THERE IS NO AIR IN THE SYSTEM.

DEPRESSURIZING THE AIR RIFLE

1. Like most PCP air rifles, the Alpha is best stored with some pressure in the reservoir. This keeps the seals forced against the sealing surfaces.
2. Make sure the air rifle is unloaded, and the Safety is on "SAFE" position. Keep the muzzle pointed in a safe direction. Be sure to wear eye protection.
3. Slowly turn the degassing screw counter-clockwise, using a 2.5mm Allen wrench. DO NOT rotate more than 2 revolutions.
4. DO NOT remove the degassing screw completely as the screw should remain with the stock.
5. After the rifle is depressurized, use a 2.5mm Allen wrench to tighten the degassing screw by turning clockwise.
6. Check the pressure gauge to make certain all pressure has been released from this air rifle.

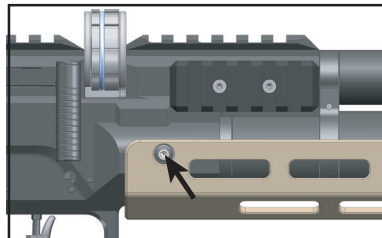

! WARNING: PERFORMING THE ABOVE PROCEDURE MAY EXHAUST AIR FROM THE BARREL AT A HIGH RATE AND COULD DISCHARGE A PELLET THAT IS CHAMBERED. ALWAYS MAKE CERTAIN THIS AIR RIFLE IS POINTED AT A SAFE DIRECTION.

LOADING THE ROTARY MAGAZINE

1. Load the first pellet into the empty loading holes as shown in the Step 1 and Step 2 images.
2. Rotate the magazine counterclockwise by one hole and load the pellets in the empty hole.
3. Repeat this until the magazine is fully loaded.

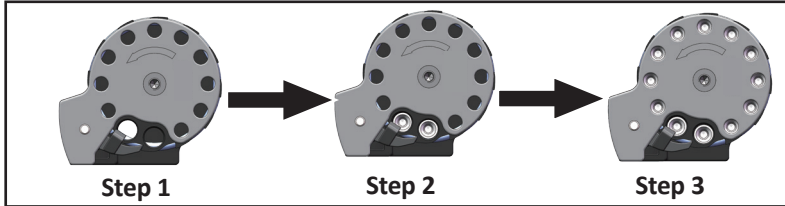

INSERTING THE ROTARY MAGAZINE

- 1) Make sure the Safety is on "SAFE" position and keep the muzzle pointed in a safe direction.
- 2) Pull the sidelever back to the cocked position.
- 3) With the side of the magazine you loaded the pellets into facing the back of the air rifle, insert the magazine from the right side and push it to the left until it snaps into place.
- 4) Push the bolt forward until it stops, to chamber a pellet.
- 5) This air rifle is now ready to fire.
- 6) Only one pellet should be pushed into the chamber each time.

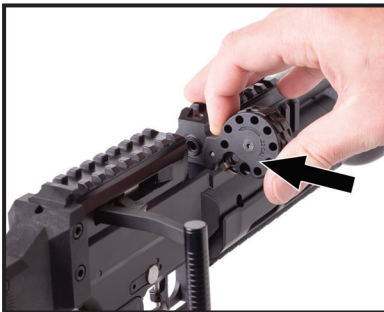

FOLDING AND REMOVING THE STOCK

To fold the stock, locate the button in (Fig. 1) and depress it. With it pressed in, the stock can be folded to the left (Fig. 2).

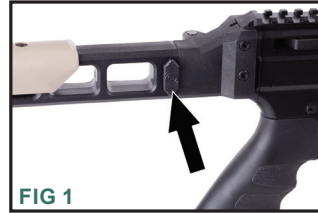

There are two magnets that keep the stock secured when folded. One is located in the stock, the other on the action of the air rifle (Fig. 3 & 4).



The stock is attached to a picatinny rail at the rear of the action. To remove it, locate the two allen head screws on the right side of the stock. Remove them using a 2.5mm allen key, turning counter-clockwise until the screw can be completely removed (Fig. 5). Once both screws are removed, the stock can be pushed up or down to remove it from the rail (Fig. 6).



To install the stock, follow the above procedure in reverse order. In order to securely attach the stock, it will be necessary to align each screw with an open slot in the picatinny rail.



LOADING & SHOOTING INSTRUCTIONS

- 1) Make sure the safety is on “SAFE” position and keep the muzzle pointed in a safe direction.
- 2) Make sure the reservoir is filled with sufficient air.
- 3) Pull the side-lever action back to the cocked position.
- 4) Place the rotary magazine into the receiver, and make sure it is installed correctly.
- 5) Push the side-lever action forward fully to the closed position to chamber a pellet.
- 6) Move the safety to the “FIRE” position.
- 7) Aim at target, pull the trigger and shoot.
- 8) When you are finished shooting, make sure there are no pellets remaining in the chamber.

! WARNING: BE SURE THE AIRGUN IS ALWAYS POINTED IN A SAFE DIRECTION. NEVER POINT THE AIRGUN AT ANYONE EVEN IF IT IS UNLOADED. ALWAYS ASSUME AND HANDLE THE AIRGUN AS IF IT WERE LOADED AND READY TO FIRE.

! WARNING: TREAT YOUR AIR RIFLE AS IF IT IS ALWAYS LOADED AND READY TO FIRE. ALWAYS KEEP THE MUZZLE POINTED IN A SAFE DIRECTION. BE AWARE OF RICOCHET. NEVER SHOOT AT HARD SURFACES OR INTO WATER.

TRIGGER ADJUSTMENT

⚠ IMPORTANT: THIS AIR RIFLE IS FOR ADULTS. THE TRIGGER HAS BEEN FACTORY SET TO A SETTING THAT WILL SUIT MOST HUNTING AND TARGET USES. THEREFORE, ADVANCE CALIBRATION IS NOT REQUIRED.

⚠ WARNING: ADJUSTMENT OF THE TRIGGER SCREWS COULD INHIBIT PROPER FUNCTION OF THE SAFETY. IT MAY CAUSE THE SAFETY TO NOT POINT AT “SAFE” OR “FIRE” POSITION. ALWAYS CHECK FOR FULL ENGAGEMENT AND SMOOTH FUNCTION OF THE SAFETY UPON COMPLETION OF ANY CHANGES TO THE ADJUSTMENT SCREWS.

⚠ WARNING: ADJUSTMENT TO THE TRIGGER ASSEMBLY COULD ALLOW THIS AIR RIFLE TO FIRE IF DROPPED OR JARRED EVEN WITH OR WITHOUT THE SAFETY ENGAGED. THIS CAN CAUSE SERIOUS INJURIES OR DEATH.

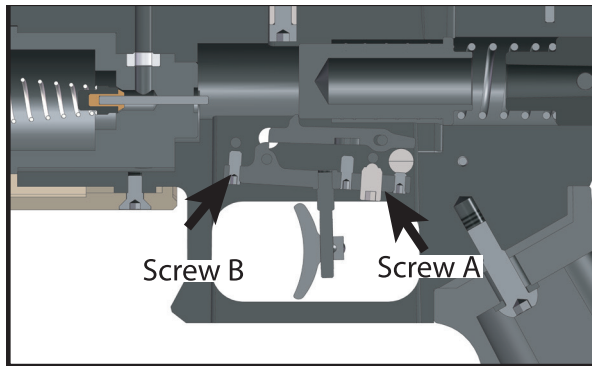

Before making any adjustments to the trigger, make sure the rifle is unloaded and that the rifle is not cocked. Always keep the rifle pointed in a safe direction.

Screw A uses a 2.5mm allen wrench and adjusts second stage release weight. Adjusting the screw clockwise will increase the release weight. Adjusting the screw counter clockwise will decrease the release weight.

Screw B uses a 1.5mm allen wrench and adjusts the sear engagement and length of trigger travel. Adjusting the screw clockwise will increase the engagement and travel. Adjusting the screw counter-clockwise will decrease engagement and travel.

⚠ IMPORTANT: DO NOT MAKE LARGE ADJUSTMENTS TO THESE SCREWS. ADJUST IN SMALL INCREMENTS AND TEST FOR PROPER FUNCTION BEFORE ADJUSTING FURTHER.

MAINTENANCE

Lubricating and Cleaning

Every 3 months or 1000 shots apply pure silicone oil sparingly to the following parts:

- The surface of the valve pin
- The seal of loading port
- It is recommended to clean the barrel with a cleaning rod every 3 months or every 1000 shots.
- Never lubricate inside the barrel.
- Before you begin oiling or cleaning your air rifle, always check to make sure it is unloaded.
- Always be sure your air rifle barrel is clean and not blocked.
- After cleaning, ensure that no cleaning patch or other obstruction remains in the barrel.

Fill Probe Seal Replacement

It is normal for the o-ring seals on the fill probe to wear over time and with use. If you hear air leaking from the fill port during filling, this indicates these seals should be replaced. Always replace both seals.

⚠ WARNING: BE SURE THE AIRGUN IS ALWAYS POINTED IN A SAFE DIRECTION. NEVER POINT THE AIRGUN AT ANYONE EVEN IF IT IS UNLOADED. ALWAYS ASSUME AND HANDLE THE AIRGUN AS IF IT WERE LOADED AND READY TO FIRE.

TROUBLESHOOTING

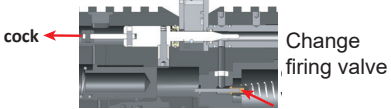
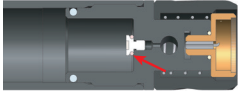
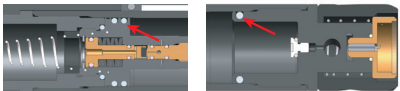
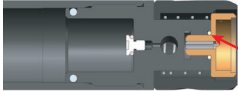
| | Issue | Solution | |
|---|---|---|--|
| 1 | Leaking from fill port while filling with air | Replace fill probe o-rings |  |
| 2 | Air coming out of the barrel | If this occurs during filling, cock the gun and it should stop. If this occurs after the rifle is filled, cock the gun. If the leakage does not stop after cocking, it is likely necessary to replace the firing valve. |  |
| 3 | Leakage at filler hole after charging. | Replace intake valve O-ring. |  |
| 4 | Leakage at mount place of exhaust/intake valve and air reservoir. | Replace intake valve O-ring. |  |
| 5 | Leakage at pressure gauge when charging. | Replace pressure gauge O-ring. |  |

⚠ WARNING: ISSUES 2 - 5 SHOULD BE RESOLVED BY A MANUFACTURER AUTHORIZED REPAIR PROFESSIONAL. DISASSEMBLY OR INSTALLATION OF PARTS IN AN ATTEMPT TO RESOLVE ONE OF THESE ISSUES BY AN UNAUTHORIZED PERSON OR FACILITY MAY VOID OR LIMIT YOUR MANUFACTURER WARRANTY.

For service or to locate the nearest authorized repair center to you, please contact Air Venturi directly by calling 216-220-1180.

WARRANTY

Your Air Venturi Alpha Rifle is manufactured to the highest standards, using quality materials to give a lifetime of service. In the unlikely event there are any defects in materials or workmanship in the first twelve (12) months after retail purchase, we will repair or replace your airgun under warranty. Keep your original purchase receipt to obtain warranty repairs.

What is covered: Replacement parts and labor. Transportation charges to consumer for return of repaired product.

The warranty will be invalid if:

- The airgun has been disassembled and incorrectly reassembled.
- The airgun is found to have lubrication not recommended by Air Venturi.
- The airgun has been fitted with non-Air Venturi parts.
- The airgun has been misused or abused.
- The original purchase receipt cannot be presented.

The warranty does NOT cover:

- O-rings, screws, seals, springs or stocks.
- Any damages or faults caused by owner misuse or action.
- Shipment damage of the airgun to or from Air Venturi.
- Transportation charges to Air Venturi for defective products.
- Damages caused by abuse or failure to perform normal maintenance.
- Parts subject to normal wear and tear.
- Consequential damages, incidental damages or incidental expenses including damage to property.
- Any other expense.

Note: Some states do not allow the exclusion or limitation of incidental or consequential damages, so the above limitation or exclusion may not apply to you.

This warranty is in addition to your statutory rights. To register your warranty, the card below must be completed and returned to Air Venturi within 30 days of purchase. Retain your sales receipt as proof of purchase.

Warranty claims for U.S. and Canadian Customers: Call Air Venturi at 216-220-1180 before returning any product.

Implied warranties: Any implied warranties, including the implied warranties of merchantability and fitness for a particular purpose, are limited in duration to one year from date of retail purchase.

Note: Some states do not allow limitations on how long an implied warranty lasts, so the above limitation may not apply to you.

To the extent any provision of this warranty is prohibited by federal, state or municipal law which cannot be preempted, it shall not be applicable. This warranty gives you specific legal rights, and you may also have other rights which vary from state to state and country to country.



AIR VENTURI®

5135 Naiman Parkway, Cleveland, OH 44139

Ph: 216-292-2570 • fax: 216-373-0086

www.airventuri.com